

School Site Plan  
VALLEY VIEW MIDDLE SCHOOL

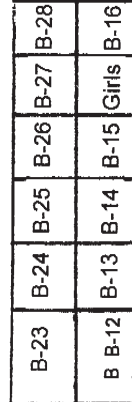

Amphitheater

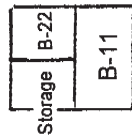
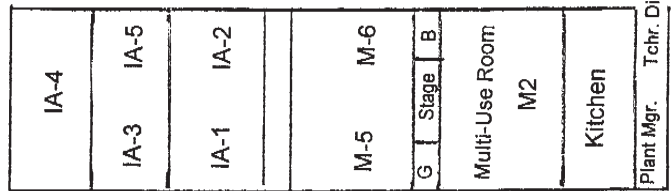
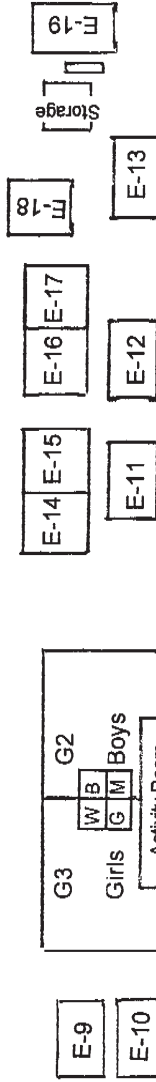
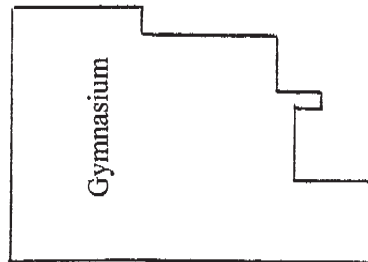
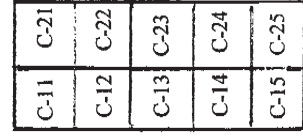
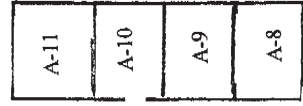

ADA Restroom

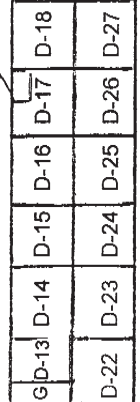
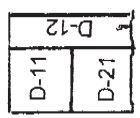

Valley View Middle School  
3347 Tapo Street  
Simi Valley, Calif. 93063  
(805) 520-6820

Tapo Street



CAMPUS MAP OF AVIARA OAKS MIDDLE & ELEMENTARY SCHOOLS, CARLSBAD

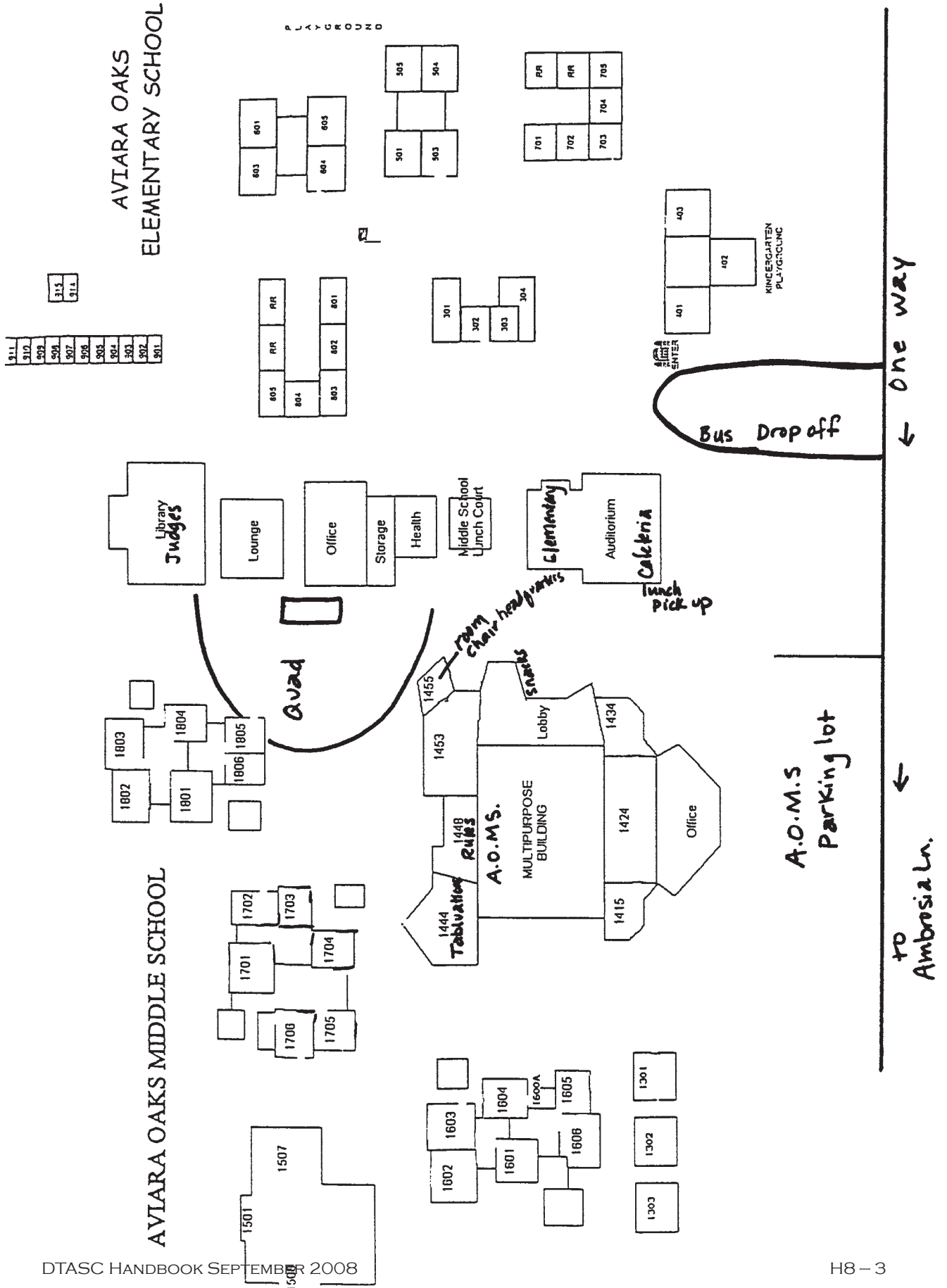

CAMPUS MAP OF DODSON MIDDLE SCHOOL, RANCHO PALOS VERDES



**Dodson Middle School**  
**28014 Montereyna Drive**  
**Rancho Palos Verdes, CA 90275**

Revised 2/12/03 lg

Birmingham High School

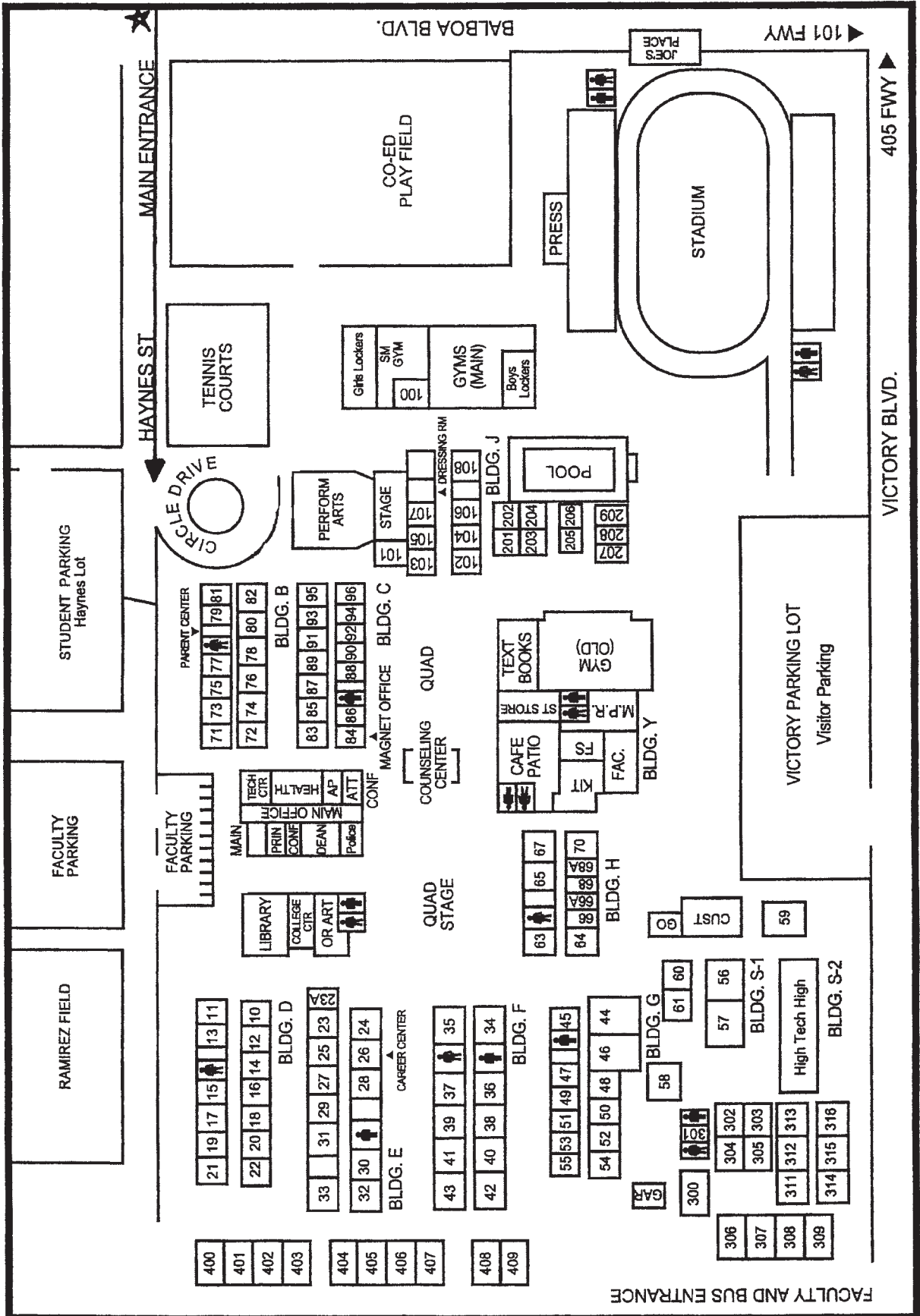

CAMPUS MAP OF SHERMAN OAKS CENTER FOR ENRICHED STUDIES, RESEDA

Victory Boulevard

**SHERMAN OAKS CENTER FOR ENRICHED STUDIES**

18605 Erwin Street Reseda, CA 91335

phone (818) 342-5175

fax (818) 344-5909

24 Hour Knightline (818) 343-7200

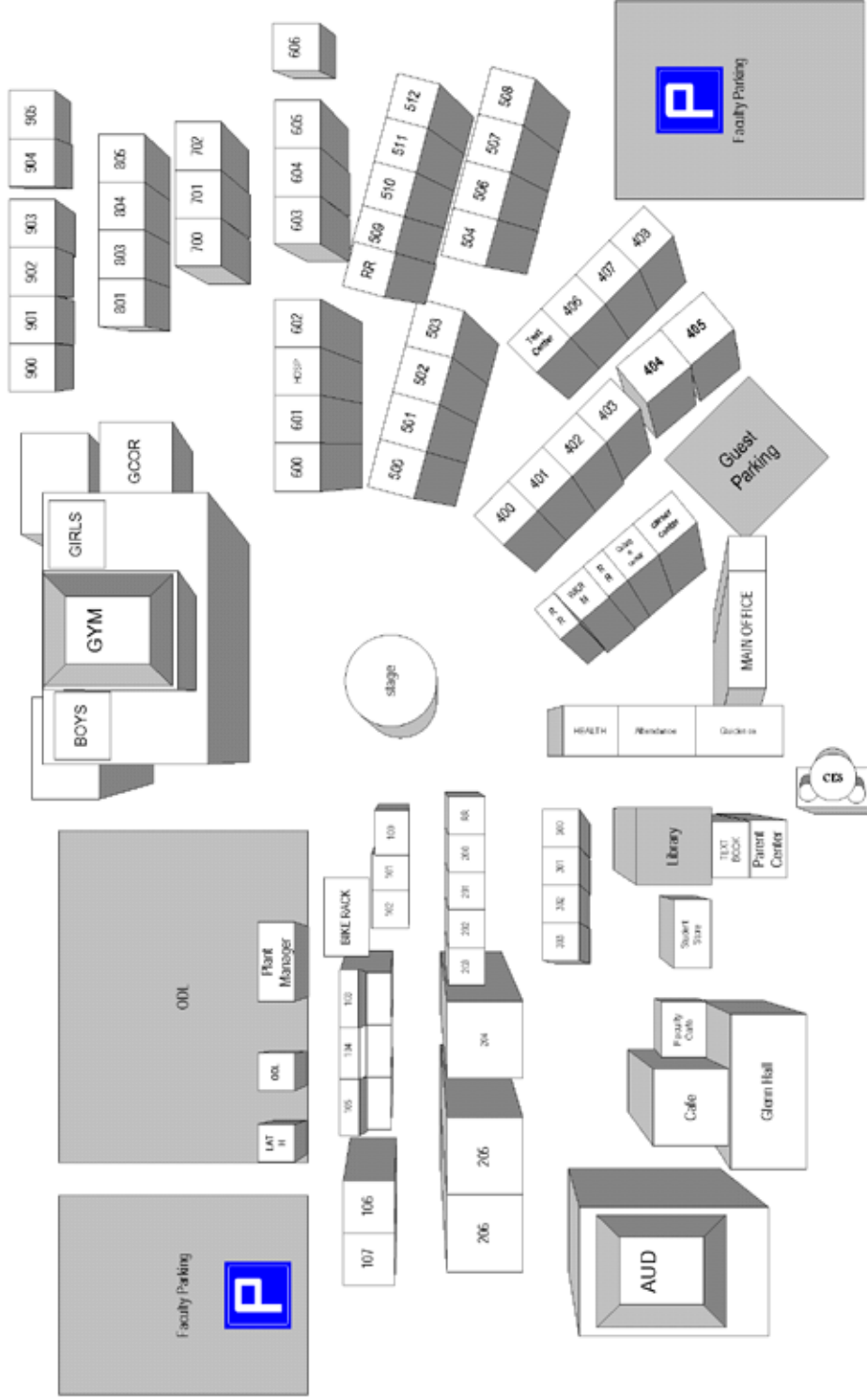

Yonda Avenue

Reseda Boulevard

18605 Erwin Street



TECHWORKS 2001-2002

CAMPUS MAP OF COLONY HIGH SCHOOL, ONTARIO

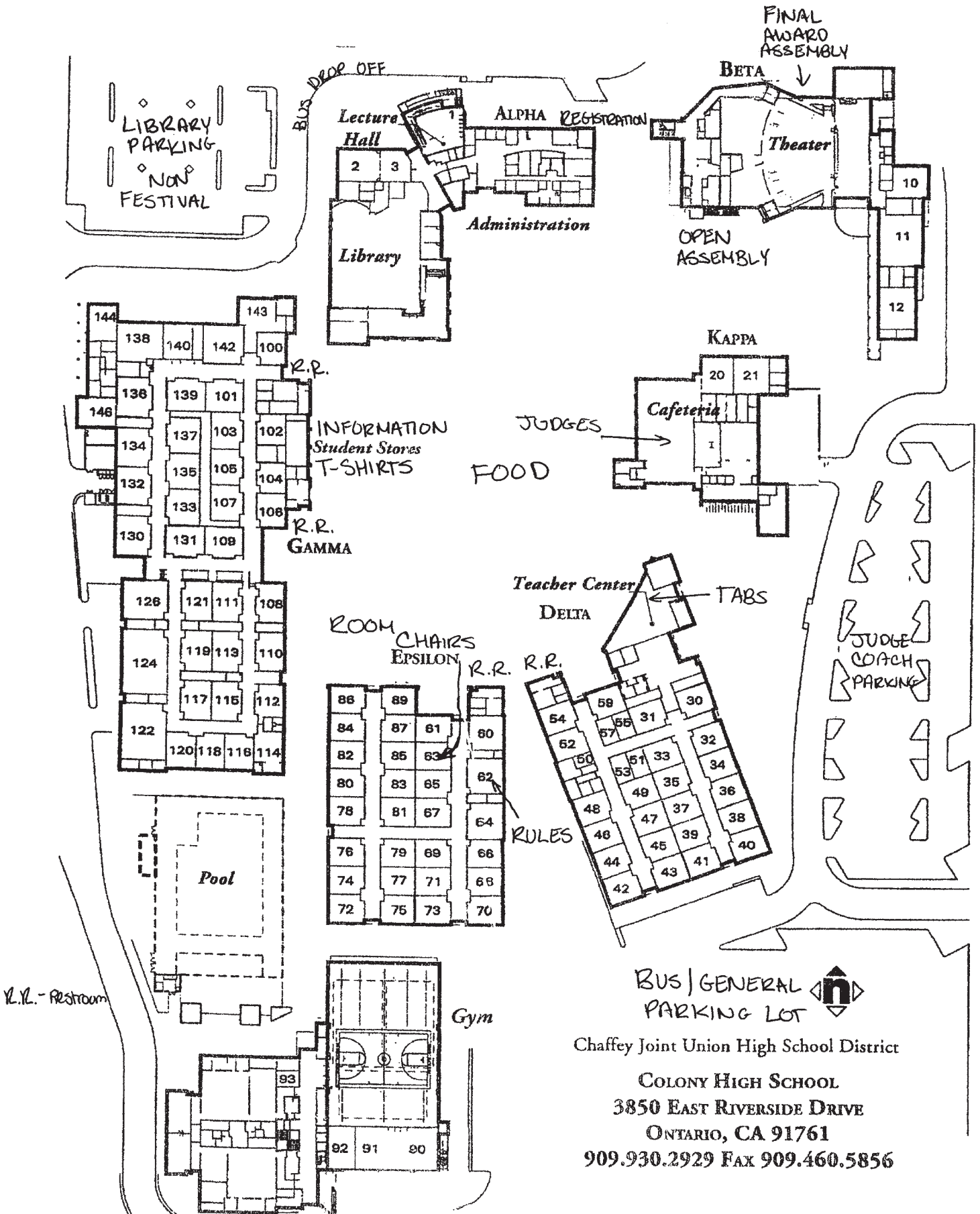



CAMPUS MAP OF ST. JOSEPH'S HIGH SCHOOL, LAKEWOOD

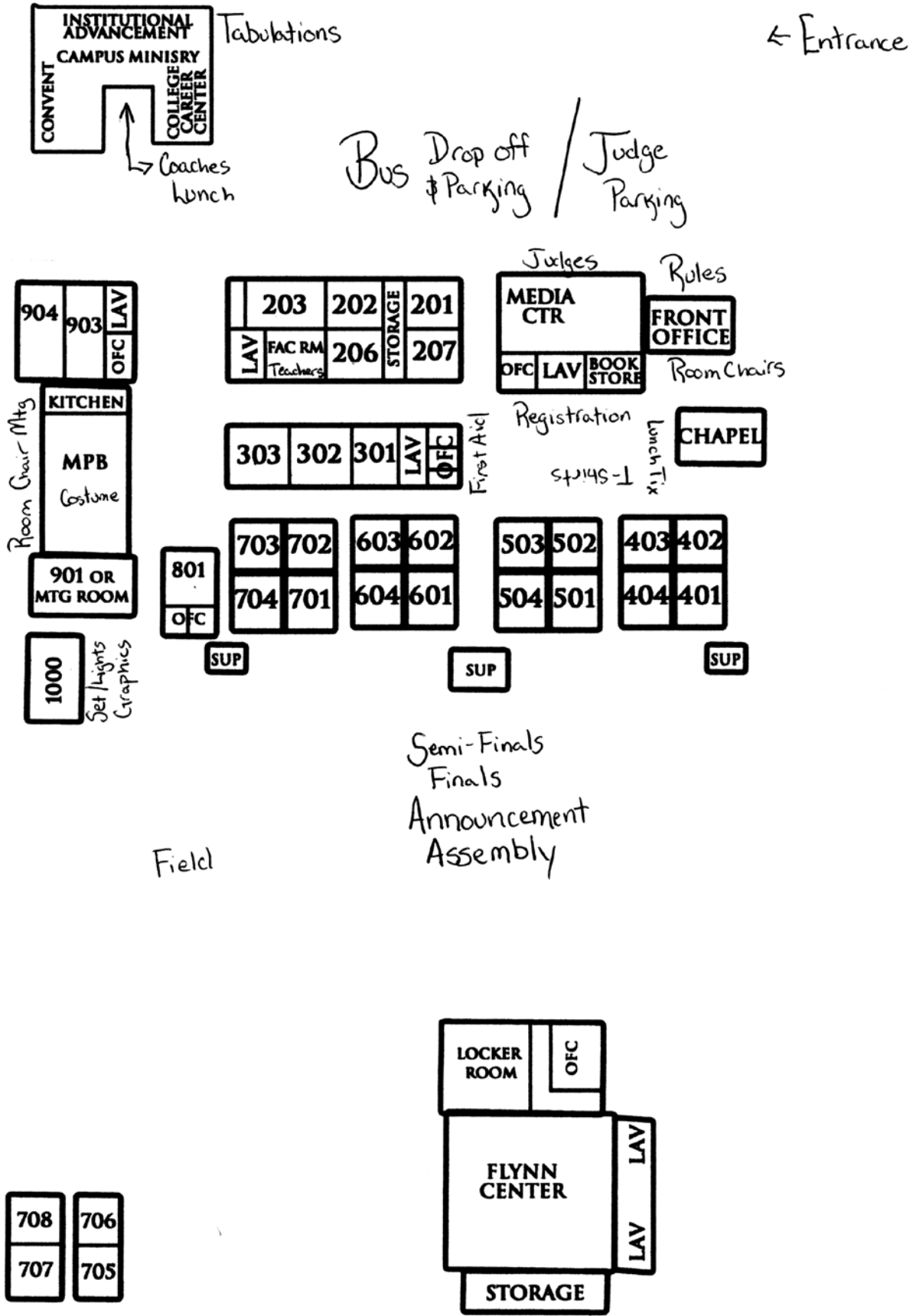



CAMPUS MAP OF ORVILLE WRIGHT MIDDLE SCHOOL, WESTCHESTER

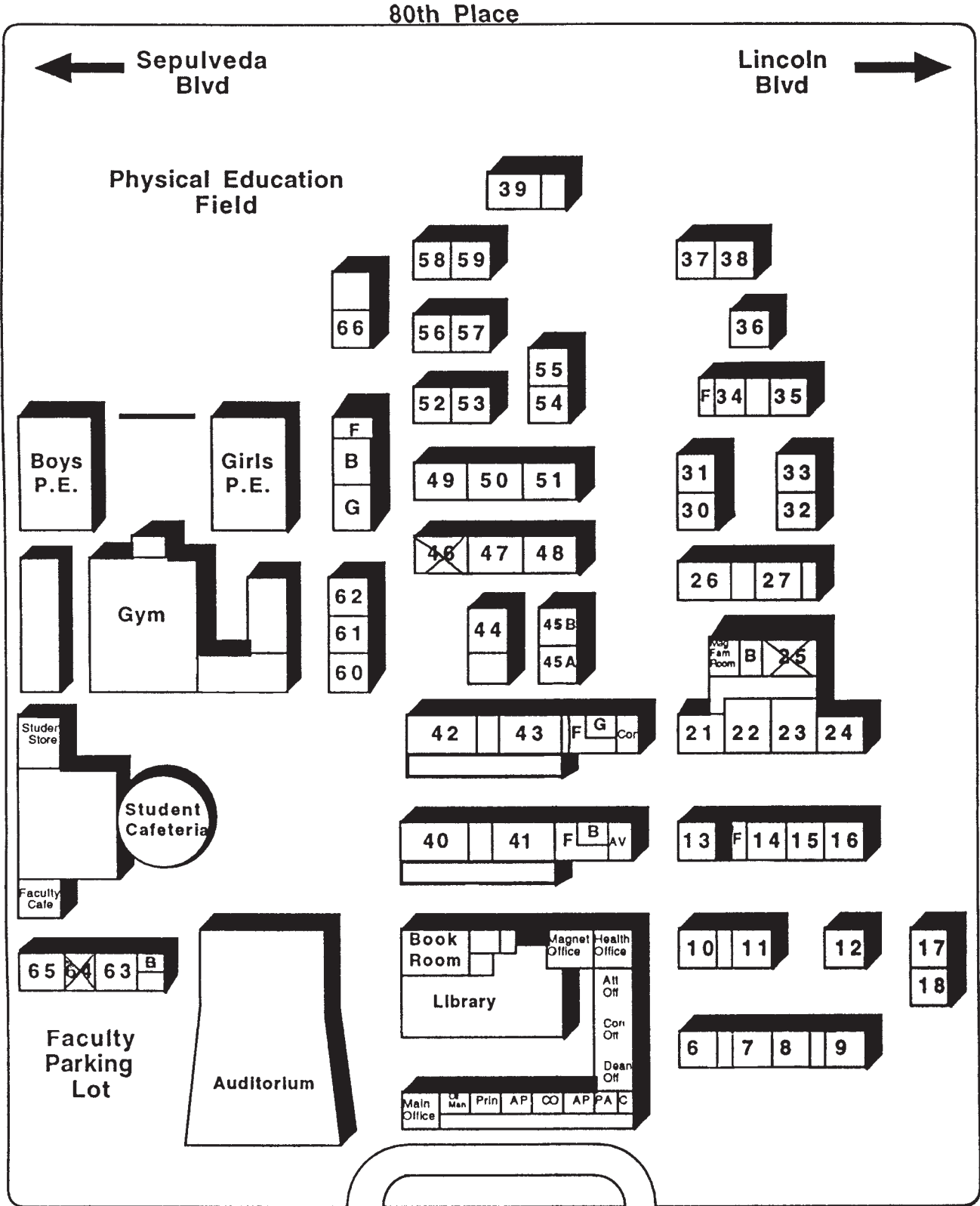

80th Street

**Orville Wright Middle School**  
 6550 W. 80th Street Los Angeles California 90045

# CALIFORNIA HIGH SCHOOL

9800 S. MILLS AVENUE WHITTIER, CALIFORNIA 90604

(562) 698 - 8121 EXTENSION 3000

**LEGEND**

- G - GIRL'S REST ROOM
- B - BOY'S REST ROOM
- F - FACULTY REST ROOM
- S - STORAGE
- O - OFFICE



DR. BY ARTHUR RODRIGUEZ 2/19/97

REVISED BY J. HILLS 2/18/00

N. BENSON 9/20/00

A. PEREZ 2/6/05

REVISED BY MR. ALVAREZ 8/28/06

CAMPUS MAP OF CHATSWORTH HIGH SCHOOL, CHATSWORTH

Chatsworth High School  
LEMARSH ST

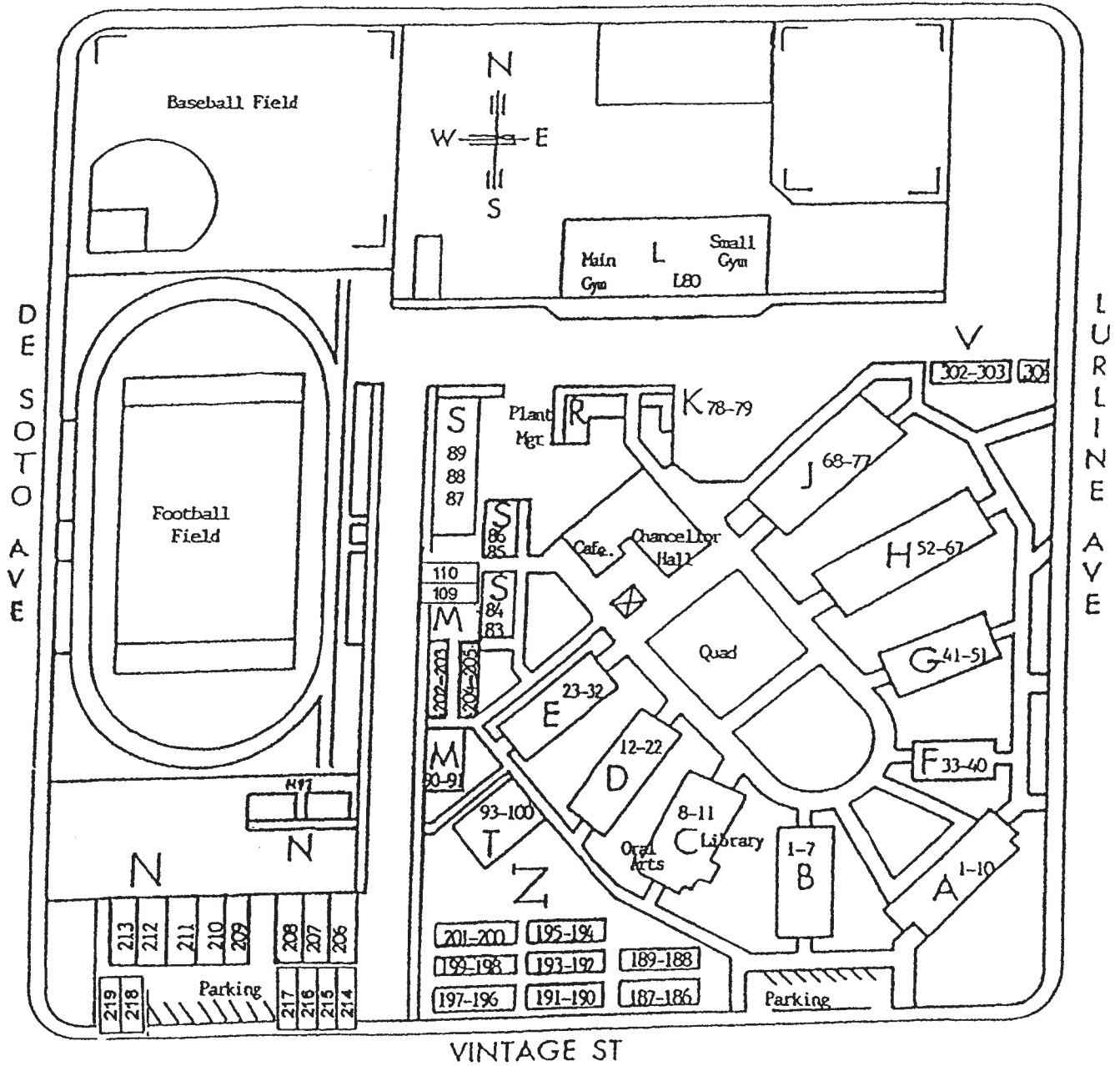

CAMPUS MAP OF VALENCIA HIGH SCHOOL, PLACENTIA

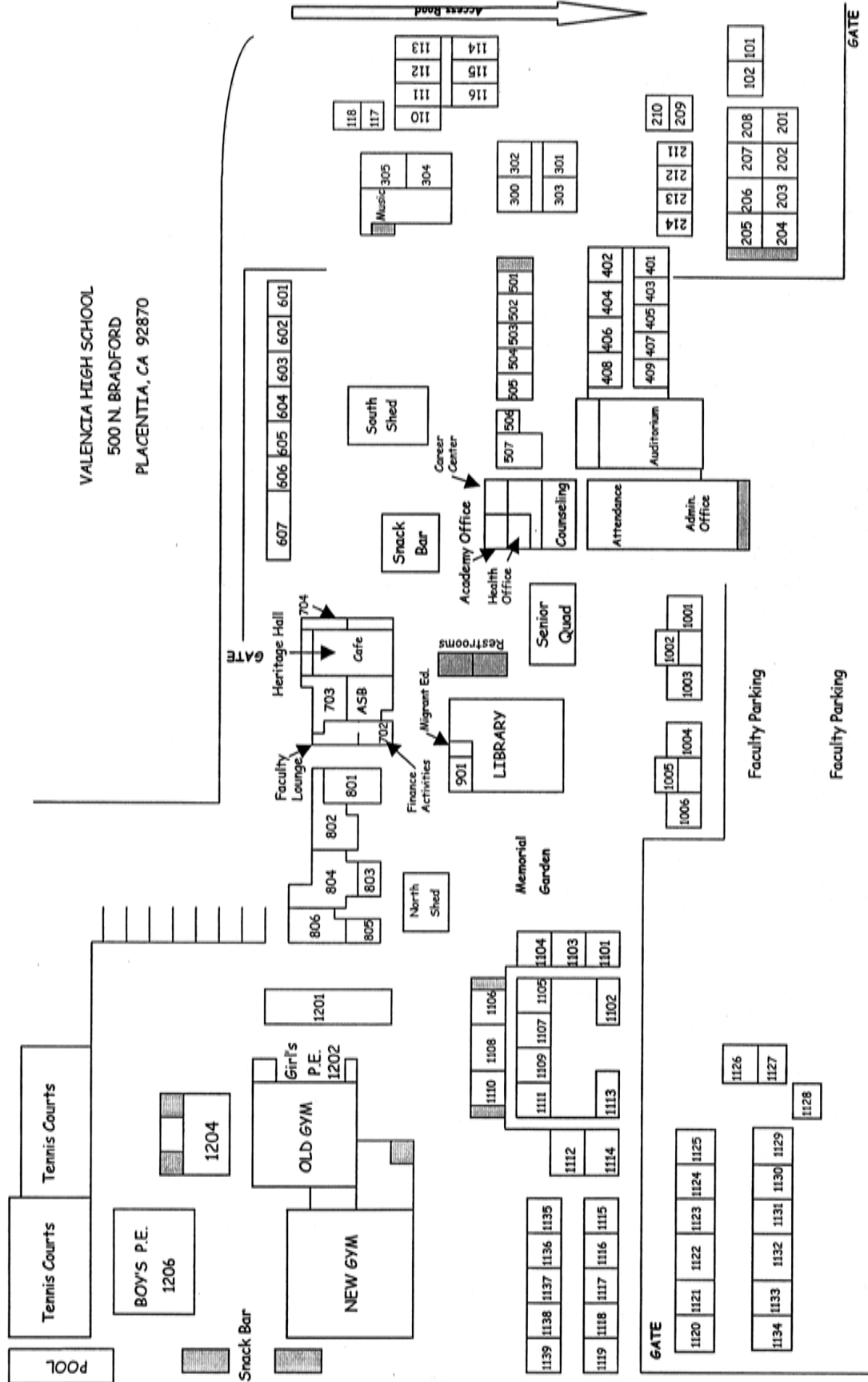



## Millikan Middle School

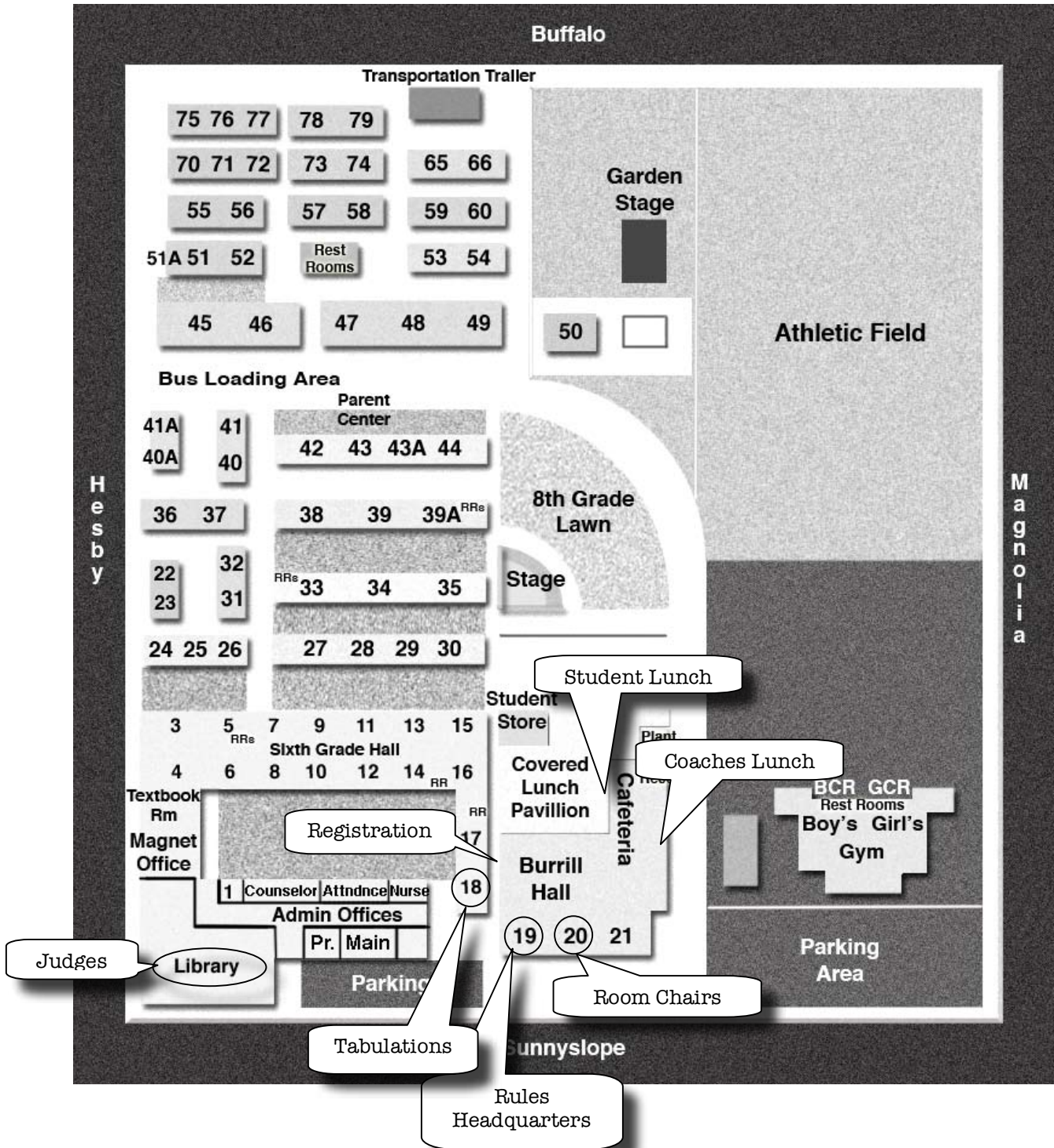

5041 Sunnyslope Ave., Sherman Oaks, CA. 91423, 818.788.5020

# JOHN BURROUGHS HIGH SCHOOL

## MAP and EMERGENCY PLAN

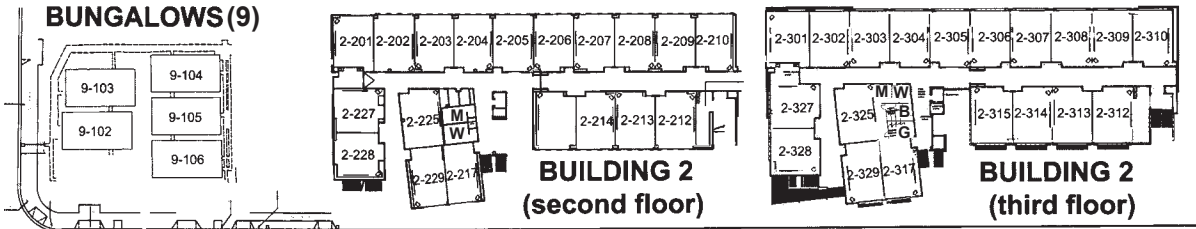

**JUDGES:** In case of emergency, lead students to baseball field.

Parish Place

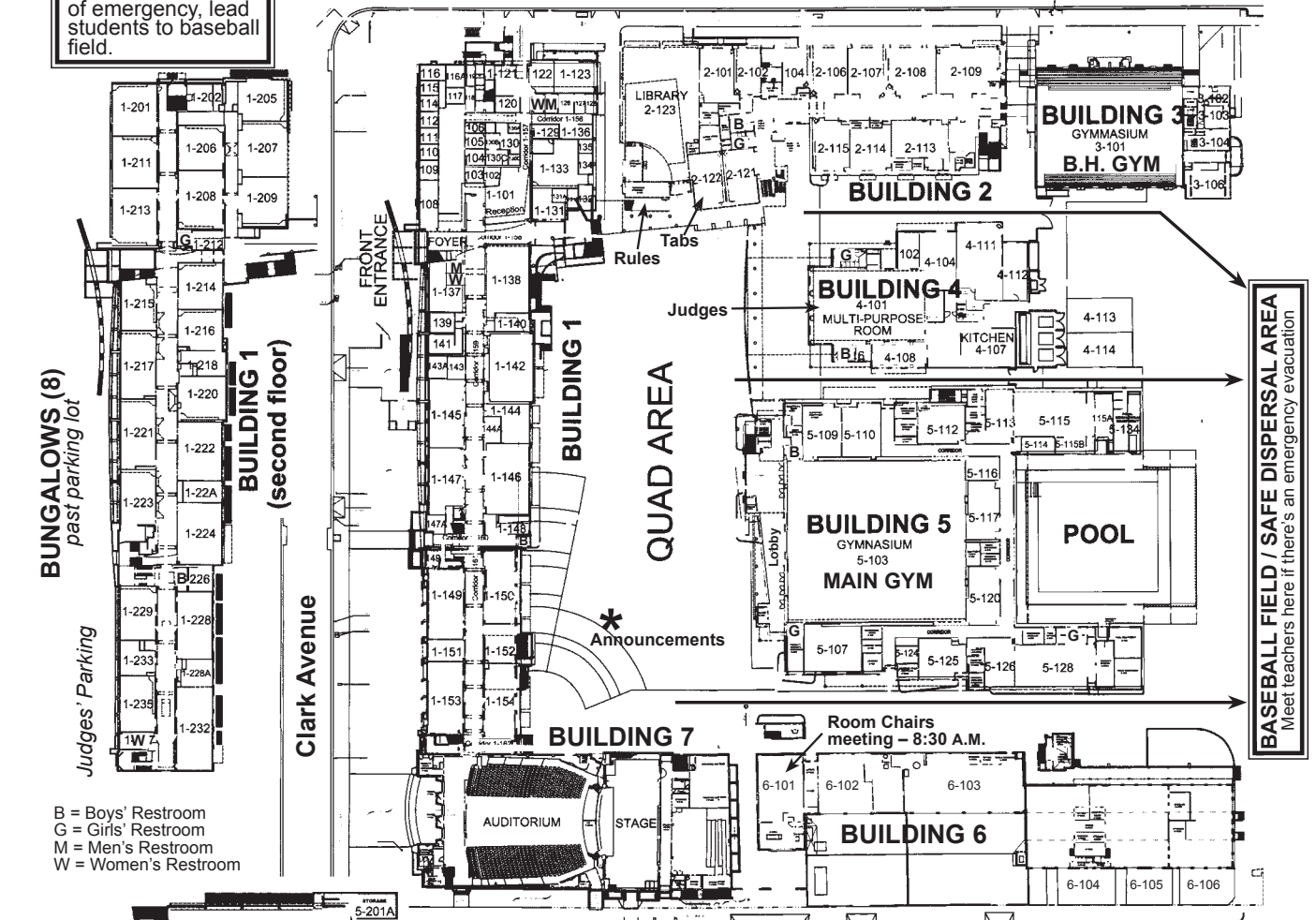

B = Boys' Restroom  
G = Girls' Restroom  
M = Men's Restroom  
W = Women's Restroom

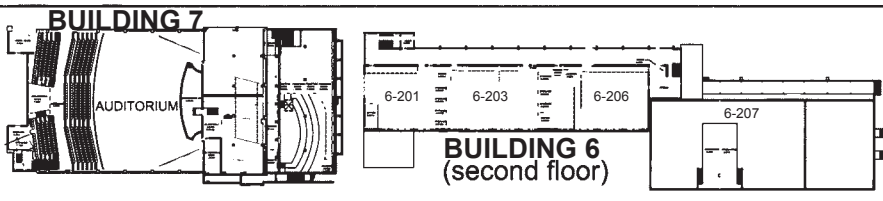
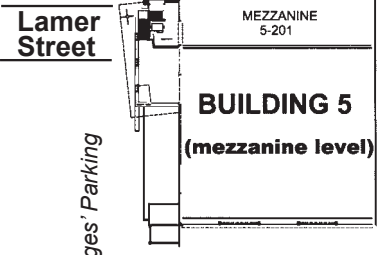

**Explanation of Room Numbers:** The first number is the building. The second number is the floor.  
 For Example: 6-101 = Building 6, 1st floor. 1-224 = Building 1, 2nd floor. 2-312 = Building 2, 3rd floor.  
 8-102 = Bungalows back of parking lot. 9-104 = Bungalows across Parish Place.  
 Please note: Elevators are for adults and handicapped persons only. Cross streets only at crosswalks.

CAMPUS MAP OF RESEDA HIGH SCHOOL, RESEDA

